

HP Discovery and Design
Fayetteville State University
Knuckle Science 3rd Floor
Rev. A
Date: February 8, 2008

Lisa Jefferson
Technical Consultant, Hewlett-Packard Co.



Current State: Fayetteville State University, NC/Knuckle Science /Floor 3



Monday, February 11, 2008

| Legend | |
|-------------|---------------------|
| Device Type | |
| Color | Description |
| | B&W Device |
| | Color Device |
| Connection | |
| Color | Description |
| | Networked connected |
| Device Type | |
| Shape | Description |
| ☆ | MFP |
| ■ | Copier |
| ○ | Printer |
| ▲ | Fax |
| ◆ | Other |



= couldn't get in

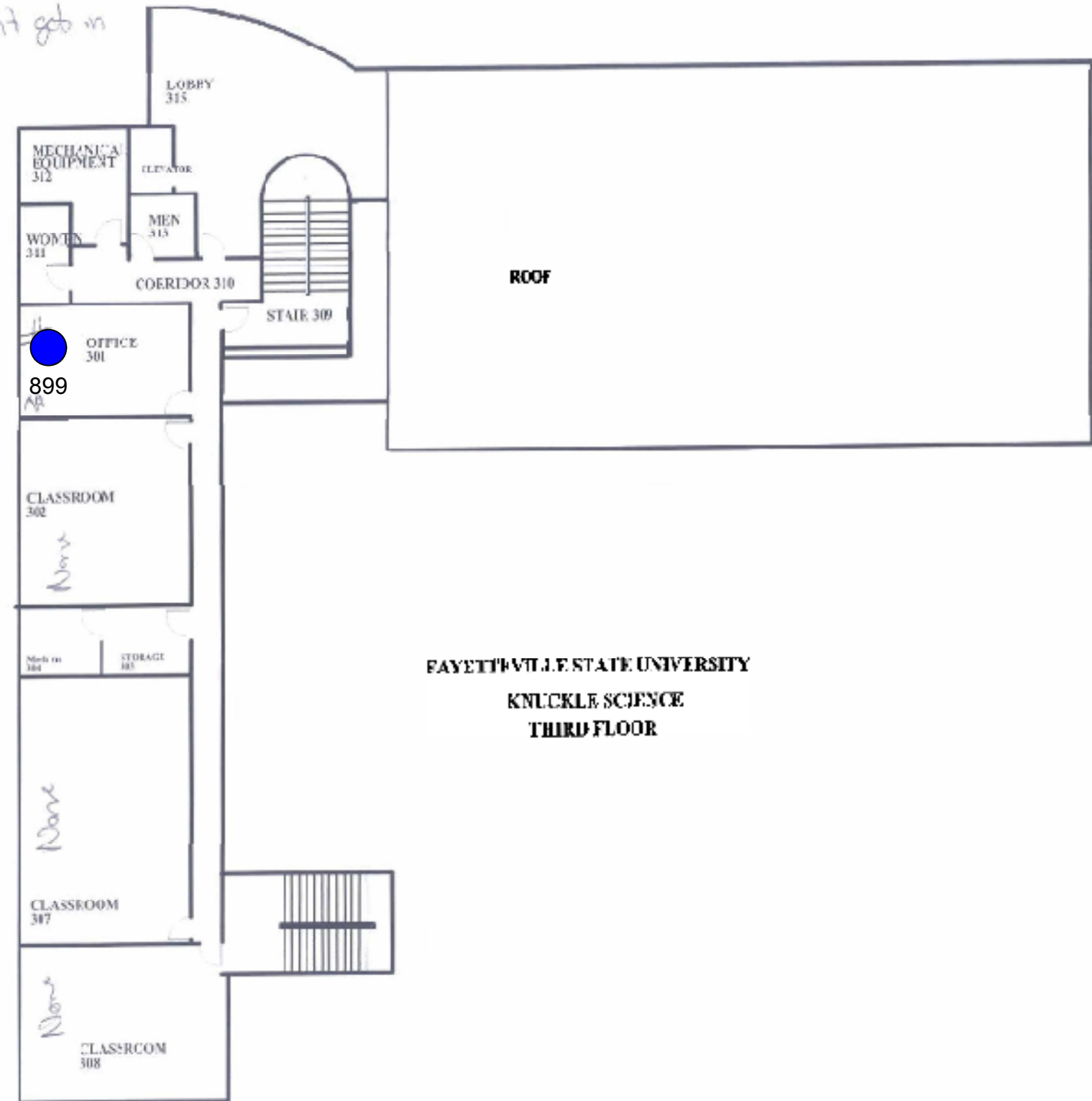

Future State: Fayetteville State University, NC/Knuckle Science/Floor 3



Monday, February 11, 2008

| Legend | | |
|----------------------|-------|-------------------|
| Future State Devices | | |
| Symbol | Count | Description |
| 8888 | 1 | HP LaserJet 4350n |

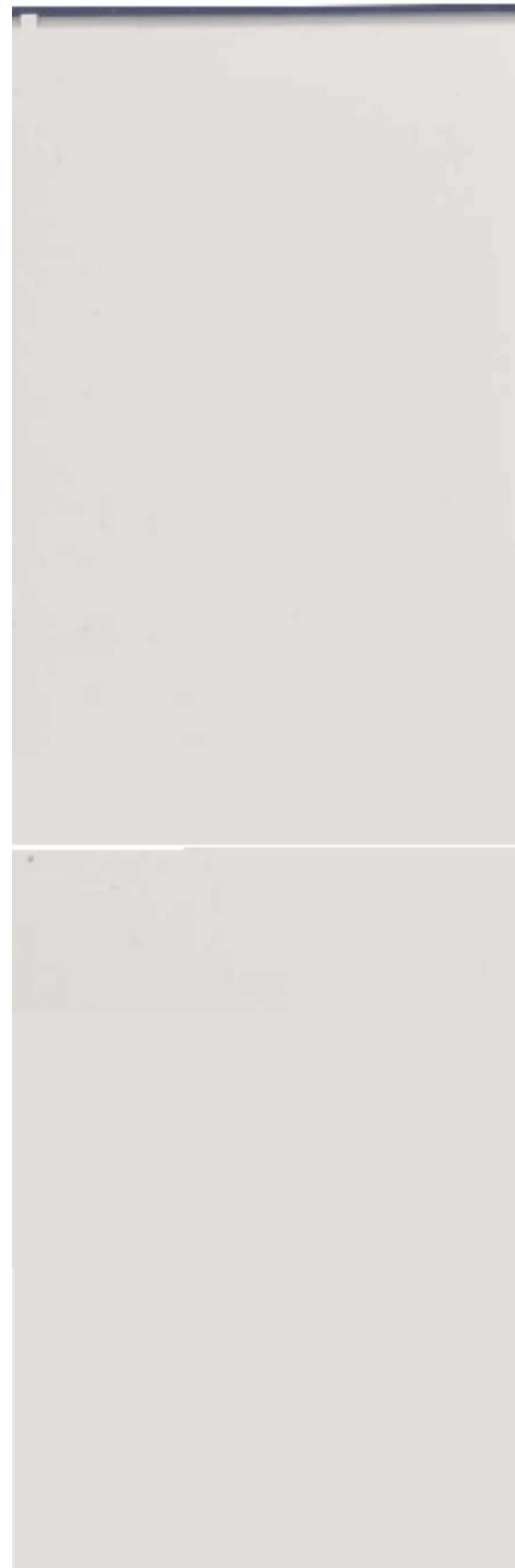

= couldn't get in

